



435 Eby Creek Site Lighting

Specification By

Apollo Lighting  
20 Sunset Dr Suite 9  
Basalt, CO 81621  
(970)984-8859  
suzanne@apollo.lighting



# Submittal Spec Sheet

Dynamically Generated

Series: WDGE2

Date: 3/23/2022

Project: 435 EBY CREEK

Group/Type: A

Qty: 4

## WDGE2 LED Wall Mount

Architectural Wall Luminaire Size 2 – up to 6,000 lumens



### Product Submittal Description:

Wall pack, LED, Package 5, 3000K, 80CRI, Visual forward throw, 120-277V, Surface mount, Dark bronze finish, super durable



The product images shown are for illustration purposes only and may not be an exact representation of the product.

[↓ IES Files](#)

[↓ BIM Models](#)

[↓ Full Spec Sheet](#)

Product Webpage: [www.acuitybrands.com/products/detail/1008038](http://www.acuitybrands.com/products/detail/1008038)

Warranty: [www.acuitybrands.com/support/warranty/terms-and-conditions](http://www.acuitybrands.com/support/warranty/terms-and-conditions)

**Model #: WDGE2 LED P5 30K 80CRI VF MVOLT SRM DDBXD ✓**

Series*		Lamp Type*		LED Configuration*		Correlated Color Temperature*	
WDGE2	Wall pack	LED	LED	P0	Package 0	27K	2700K
				P1	Package 1	30K	3000K
				P1SW	WDGE2 P1 package Small Window	35K	3500K
				P2	Package 2	40K	4000K
				P2SW	WDGE2 P2 package Small Window	50K	5000K
				P3	Package 3	AMB	Amber
				P3SW	WDGE2 P3 package Small Window		
				P4	Package 4		
				P5	Package 5		
Color Rendering Index*		Distribution*		Voltage*		Mounting*	
70CRI	70CRI	T1S	Type I Short	347	347V	ICW	Indirect Canopy/Ceiling Washer
80CRI	80CRI	T2M	Type II Medium	480	480V	PBBW	Premium Backbox for WST LED 2016 design
90CRI	90CRI	T3M	Type III Medium	MVOLT	120-277V	SRM	Surface mount
LW	Limited Wavelength (for AMBLW option)	T4M	Type IV Medium				
		TFTM	Forward throw medium				
		VF	Visual forward throw				
		VW	Visual wide				
Mounting 2		Driver Configuration		Dimming Wires		Dimmable/Controllable	
AWS	Architectural Wall Spacer	DS	Dual switching; Provides 50/50 luminaire operation via two independent drivers on two separate circuits	DMG	0-10v dimming wires pulled outside fixture (for use with an external control, ordered separately)	NLTAIR2	Night air gen 2 controller





# Submittal Spec Sheet

Dynamically Generated

Series: WDGE2

Date: 3/23/2022

Project: 435 EBY CREEK

Group/Type: A

Qty: 4

Photocell		Internal Control		Emergency Battery Pack		Conduit Entry	
PE	Photocell, buttontype	PIR	Motion/ambient sensor <15FT; dims to 3V	E10WH	Emergency battery backup, 10W, Hot	BCE	Bottom Conduit Entry
		PIR1FC3V	Motion/ambient sensor <15FT; photocontrol set at 1 FC; dims to 3V	E20WC	Emergency battery backup, 18W, Cold		
		PIRH	Motion/ambient sensor 15-30FT; dims to 3V	E4WH	Emergency battery backup, 4W, Hot		
		PIRH1FC3V	Motion/ambient sensor 15-30FT; photocontrol set at 1 FC; dims to 3V				
Finish*						Assembled in America	
DBLBXD	Textured black, super durable	DMBXD	Medium bronze, super durable	DWHGXD	Textured white, super durable	BAA	Buy American Act
DBLXD	Black finish, super durable	DNATXD	Textured natural aluminum, super durable	DWHXD	White, super durable		
DDBTXD	Textured dark bronze, super durable	DNAXD	Natural aluminum finish, super durable	DWJPD	White aluminium, RAL9006, super durable		
DDBXD	Dark bronze finish, super durable	DSPDXD	Textured dark grey, super durable				
DGCXD	Charcoal grey, super durable	DSPJXD	Light grey, super durable				
DGRHXD	Dark green, RAL6012, super durable	DSSTXD	Textured sandstone, super durable				
DGYGXD	Grey, RAL7040, super durable	DSSXD	Sandstone, super durable				
DGYRXD	DGYRXD	DTGXD	Tennis green, super durable				
DGYWXD	Dark grey, RAL7012, super durable	DWHDXD	White, RAL9002, super durable				

This is a dynamic specification sheet that is based on certain selections made by the user. All results generated are for informational purposes only. The user should validate the results with its agency sales representative to determine whether the product has been configured correctly before ordering. Acuity Brands Lighting is not responsible for any loss resulting from product configuration errors.

Not all versions of the product are available with all options.

Specifications subject to change without notice.

Actual performance may differ as a result of end-user environment and application.

All values are design or typical values, measured under laboratory conditions at 25 °C.

See the full specification sheet at the product page link above for full product information and detailed ordering information.

Certain airborne contaminants can diminish the integrity of acrylic and/or polycarbonate.

Visit: <http://www.acuitybrandslighting.com/library/ll/documents/specsheets/acrylic-polycarbonate-compatibility.pdf> for Acrylic-Polycarbonate Compatibility table for suitable uses.

All trademarks referenced are property of their respective owners.





# Submittal Spec Sheet

Dynamically Generated

Series: WDGE3

Date: 3/23/2022

Project: 435 EBY CREEK

Group/Type: B

Qty: 6

## WDGE3 LED Wall Mount

Architectural Wall Luminaire Size 3 – up to 12,000 lumens



### Product Submittal Description:

Wall Pack, LED, Package 4, 3000K, 80CRI, Forward Throw distribution, 120-277V, Surface mount, Dark bronze finish, super durable



The product images shown are for illustration purposes only and may not be an exact representation of the product.

[↓ IES Files](#)

[↓ BIM Models](#)

[↓ Full Spec Sheet](#)

Product Webpage: [www.acuitybrands.com/products/detail/1008040](http://www.acuitybrands.com/products/detail/1008040)

Warranty: [www.acuitybrands.com/support/warranty/terms-and-conditions](http://www.acuitybrands.com/support/warranty/terms-and-conditions)

Model #: **WDGE3 LED P4 30K 80CRI RFT MVOLT SRM DDBXD** ✓

Series*	Lamp Type*	LED Configuration*	Correlated Color Temperature*
WDGE3 Wall Pack	LED LED	P1 Package 1 P2 Package 2 P3 Package 3 P4 Package 4	30K 3000K 40K 4000K 50K 5000K
Color Rendering Index*	Distribution*	Voltage*	Mounting*
70CRI 70CRI 80CRI 80CRI	R2 IES type II R3 IES type III asymmetric R4 IES type IV forward throw RFT Forward Throw distribution	347 347V 480 480V MVOLT 120-277V	DWS Decorative Wall Spacer ICW Indirect Canopy/Ceiling Washer PBBW Premium Backbox for WST LED 2016 design SRM Surface mount
Mounting 2	Dimming Wires	Dimmable/Controllable	Photocell
AWS Architectural Wall Spacer	DMG 0-10v dimming wires pulled outside fixture (for use with an external control, ordered separately)	NLTAIR2 Night air gen 2 controller	PE Photocell, butontype





# Submittal Spec Sheet

Dynamically Generated

Series: WDGE3

Date: 3/23/2022

Project: 435 EBY CREEK

Group/Type: B

Qty: 6

Internal Control		Surge Protection		Emergency Battery Pack		Conduit Entry	
PIR	Motion/ambient sensor <15FT; dims to 3V	SPD10KV	Additional surge protection 10KV	E15WH	Emergency battery backup, 15W, Hot	BCE	Bottom Conduit Entry
PIR1FC3V	Motion/ambient sensor <15FT; photocontrol set at 1 FC; dims to 3V			E20WC	Emergency battery backup, 18W, Cold		
PIRH	Motion/ambient sensor 15-30FT; dims to 3V						
PIRH1FC3V	Motion/ambient sensor 15-30FT; photocontrol set at 1 FC; dims to 3V						
Finish*						Assembled in America	
DBLBXD	Textured black, super durable	DMBXD	Medium bronze, super durable	DWHGXD	Textured white, super durable	BAA	Buy American Act
DBLXD	Black finish, super durable	DNATXD	Textured natural aluminum, super durable	DWHXD	White, super durable		
DDBTXD	Textured dark bronze, super durable	DNAXD	Natural aluminum finish, super durable	DWJPD	White aluminium, RAL9006, super durable		
DDBXD	Dark bronze finish, super durable	DSPDXD	Textured dark grey, super durable				
DGCXD	Charcoal grey, super durable	DSPJXD	Light grey, super durable				
DGRHXD	Dark green, RAL6012, super durable	DSSTXD	Textured sandstone, super durable				
DGYGXD	Grey, RAL7040, super durable	DSSXD	Sandstone, super durable				
DGYRXD	DGYRXD	DTGXD	Tennis green, super durable				
DGYWXD	Dark grey, RAL7012, super durable	DWHDXD	White, RAL9002, super durable				

This is a dynamic specification sheet that is based on certain selections made by the user. All results generated are for informational purposes only. The user should validate the results with its agency sales representative to determine whether the product has been configured correctly before ordering. Acuity Brands Lighting is not responsible for any loss resulting from product configuration errors.

Not all versions of the product are available with all options.

Specifications subject to change without notice.

Actual performance may differ as a result of end-user environment and application.

All values are design or typical values, measured under laboratory conditions at 25 °C.

See the full specification sheet at the product page link above for full product information and detailed ordering information.

Certain airborne contaminants can diminish the integrity of acrylic and/or polycarbonate.

Visit: <http://www.acuitybrandslighting.com/library/ll/documents/specsheets/acrylic-polycarbonate-compatibility.pdf> for Acrylic-Polycarbonate Compatibility table for suitable uses.

All trademarks referenced are property of their respective owners.





# Submittal Spec Sheet

Dynamically Generated

Series: DSX1

Date: 3/23/2022

Project: 435 EBY CREEK

Group/Type: C

Qty: 3

## D-Series Area Size 1

DSX1 LED Area Luminaire

### Product Submittal Description:

D-Series Size 1 LED Area Luminaire, LED, Package 8, 3000K , Type III Medium, 120-277V, House-side shield, Square pole mounting, Dark bronze finish, super durable



The product images shown are for illustration purposes only and may not be an exact representation of the product.

[↓ IES Files](#)

[↓ BIM Models](#)

[↓ Full Spec Sheet](#)

Product Webpage: [www.acuitybrands.com/products/detail/209326](http://www.acuitybrands.com/products/detail/209326)

Warranty: [www.acuitybrands.com/support/warranty/terms-and-conditions](http://www.acuitybrands.com/support/warranty/terms-and-conditions)

Model #: DSX1 LED P8 30K T3M MVOLT HS SPA DDBXD ✓

Series*		Lamp Type*		LED Configuration*			
DSX1	D-Series Size 1 LED Area Luminaire	LED	LED	P1	Package 1	P6	Package 6
				P10	Package 10	P7	Package 7
				P11	Package 11	P8	Package 8
				P12	Package 12	P9	Package 9
				P13	Package 13		
				P2	Package 2		
				P3	Package 3		
				P4	Package 4		
				P5	Package 5		
Correlated Color Temperature*		Distribution*				Voltage*	
30K	3000K	BLC	Backlight control	T5M	Type V Medium	120	120V
40K	4000K	LCCO	Left Corner Cutoff Optic	T5S	Type V Short	208	208V
50K	5000K	RCCO	Right Corner Cutoff Optic	T5VS	Type V Very short	240	240V
AMBPC	Amber, Phosphor Converted	T1S	Type I Short	T5W	Type V Wide	24VDC	24V DC
		T2M	Type II Medium	TFTM	Forward throw medium	277	277V
		T2S	Type II Short	VLS	Visual comfort symmetric	347	347V
		T3M	Type III Medium			480	480V
		T3S	Type III Short			MVOLT	120-277V
		T4M	Type IV Medium			SOLAR	SOLAR
Voltage* (Cont...)		Ambient Starting Temp		Bird Deterrent		Shielding	
XVOLT	XVOLT	HA	High Ambient	BS	Bird spikes	EGS	External Glare Shield
						HS	House-side shield





# Submittal Spec Sheet

Dynamically Generated

Series: DSX1

Date: 3/23/2022

Project: 435 EBY CREEK

Group/Type: C

Qty: 3

Wiring Device		Mounting*		Driver Configuration		Dimming Wires	
WTB	Utility Terminal Block	MA	Mast arm adaptor, integral	DS	Dual switching; Provides 50/50 luminaire operation via two independent drivers on two separate circuits	DMG	0-10v dimming wires pulled outside fixture (for use with an external control, ordered separately)
		RPA	Round pole mounting				
		RPUMBA	Round pole universal mounting bracket adaptor				
		SPA	Square pole mounting				
		SPUMBA	Square pole universal mounting bracket adaptor				
		WBA	Wall mount bracket				
Dimmable/Controllable		Receptacle Type		Internal Control			
NLTAIR2	Nlight air gen 2 controller	PER	NEMA twist-lock receptacle only	PIR	Motion/ambient sensor <15FT; dims to 3V	PIRH4V	Motion/ambient sensor 15-30FT; dims to 4V
		PER5	Five-wire receptacle only (no controls)	PIR1FC3V	Motion/ambient sensor <15FT; photocontrol set at 1 FC; dims to 3V	PIRHN	Motion/ambient sensor 15-30FT- Networked
		PER7	Seven-wire receptacle only (no controls)	PIR4V	Motion/ambient sensor <15FT; dims to 4V		
				PIRH	Motion/ambient sensor 15-30FT; dims to 3V		
				PIRH1FC3V	Motion/ambient sensor 15-30FT; photocontrol set at 1 FC; dims to 3V		
Part-Night Dimming		Bi-Level Dimming		Field Adjustable		Fusing	
PNMT5D3	Midpoint, 5 hours past mid-point, 3V	BL30	Bi-level dimming, 30%	FAO	Field adjustable output	DF	Double Fuse
PNMT6D3	Midpoint, 6 hours past mid-point, 3V	BL50	Bi-level dimming, 50%			SF	Single Fuse
PNMT7D3	Midpoint, 7 hours past mid-point, 3V						
PNMTDD3	Midpoint, until dawn, 3V						
Aiming		Finish*					
L90	Left rotated optics	DBLBXD	Textured black, super durable	DMBXD	Medium bronze, super durable	DWHXD	White, super durable
R90	Right rotated optics	DBLXD	Black finish, super durable	DNATXD	Textured natural aluminum, super durable	DWJPD	White aluminium, RAL9006, super durable
		DDBTXD	Textured dark bronze, super durable	DNAXD	Natural aluminum finish, super durable		
		DDBXD	Dark bronze finish, super durable	DSPDXD	Textured dark grey, super durable		
		DGCXD	Charcoal grey, super durable	DSPJXD	Light grey, super durable		
		DGRHXD	Dark green, RAL6012, super durable	DSSTXD	Textured sandstone, super durable		
		DGYGXD	Grey, RAL7040, super durable	DSSXD	Sandstone, super durable		
		DGYWXD	Dark grey, RAL7012, super durable	DTGXD	Tennis green, super durable		
		DHBUXD	Custom Color Holophane Munsell Gray	DWHGXD	Textured white, super durable		
Assembled in America							
BAA	Buy American Act						





# Submittal Spec Sheet

*Dynamically Generated*

Series: DSX1

Date: 3/23/2022

Project: 435 EBY CREEK

Group/Type: C

Qty: 3

*This is a dynamic specification sheet that is based on certain selections made by the user. All results generated are for informational purposes only. The user should validate the results with its agency sales representative to determine whether the product has been configured correctly before ordering. Acuity Brands Lighting is not responsible for any loss resulting from product configuration errors.*

*Not all versions of the product are available with all options.*

*Specifications subject to change without notice.*

*Actual performance may differ as a result of end-user environment and application.*

*All values are design or typical values, measured under laboratory conditions at 25 °C.*

*See the full specification sheet at the product page link above for full product information and detailed ordering information.*

*Certain airborne contaminants can diminish the integrity of acrylic and/or polycarbonate.*

*Visit: <http://www.acuitybrandslighting.com/library/ll/documents/specsheets/acrylic-polycarbonate-compatibility.pdf> for Acrylic-Polycarbonate Compatibility table for suitable uses.*

*All trademarks referenced are property of their respective owners.*





Catalog Number	SSS 25 5C DM19AS DDBXD
Notes	
Type	C

## FEATURES & SPECIFICATIONS

**INTENDED USE** — These specifications are for USA standards only. Square Straight Steel is a general purpose light pole for up to 39-foot mounting heights. This pole provides a robust yet cost effective option for mounting area lights and floodlights.

### CONSTRUCTION

**Pole Shaft:** The pole shaft is of uniform dimension and wall thickness and is made of a weldable-grade, hot-rolled, commercial-quality steel tubing with a minimum yield of 55 KSI (11-gauge, .1196"), or 50 KSI (7-gauge, .1793"). Shaft is one-piece with a full-length longitudinal high-frequency electric resistance weld. Uniformly square in cross-section with flat sides, small corner radii and excellent torsional qualities. Available shaft widths are 4", 5" and 6".

**Pole Top:** Options include tenon top, drilled for side mount fixture, tenon with drilling (includes extra handhole) and open top. Side drilled and open top poles include a removable top cap.

**Handhole:** A reinforced handhole with grounding provision is provided at 18" from the base on side A. Positioning the handhole lower may not be possible and requires engineering review; consult Tech Support-Outdoor for further information. Every handhole includes a cover and cover attachment hardware. The handhole has a nominal dimension of 2.5" x 5".

**Base Cover:** A durable ABS plastic two-piece full base cover, finished to match the pole, is provided with each pole assembly. Additional base cover options are available upon request.

**Anchor Base/Bolts:** Anchor base is fabricated from steel that meets ASTM A36 standards and can be altered to match existing foundations; consult factory for modifications. Anchor bolts are manufactured to ASTM F1554 Standards grade 55, (55 KSI minimum yield strength and tensile strength of 75-95 KSI). Top threaded portion (nominal 12") is hot-dipped galvanized per ASTM A-153.

**HARDWARE** — All structural fasteners are high-strength galvanized carbon steel. All non-structural fasteners are galvanized or zinc-plated carbon steel or stainless steel.

**FINISH** — Extra durable painted finish is coated with TGIC (Triglycidyl Isocyanurate) Polyester powder that meets 5A and 5B classifications of ASTM D3359. Powder-coat finishes include Dark Bronze, White, Black, and Natural Aluminum colors. Architectural Colors and Special Finishes are available by quote and include, but are not limited to Paint over Hot-dipped Galvanized, RAL Colors, Custom Colors and Extended Warranty Finishes.

**BUY AMERICAN** — Product with the BAA option is assembled in the USA and meets the Buy America(n) government procurement requirements under FAR, DFARS and DOT. Please refer to [www.acuitybrands.com/buy-american](http://www.acuitybrands.com/buy-american) for additional information.

**INSTALLATION** — **Do not** erect poles without having fixtures installed. Factory-supplied templates must be used when setting anchor bolts. Lithonia Lighting will not accept claim for incorrect anchorage placement due to failure to use Lithonia Lighting factory templates. If poles are stored outside, all protective wrapping must be removed immediately upon delivery to prevent finish damage. Lithonia Lighting is not responsible for the foundation design.

**WARRANTY** — 1-year limited warranty. This is the only warranty provided and no other statements in this specification sheet create any warranty of any kind. All other express and implied warranties are disclaimed. Complete warranty terms located at: [www.acuitybrands.com/support/warranty/terms-and-conditions](http://www.acuitybrands.com/support/warranty/terms-and-conditions)

**NOTE:** Actual performance may differ as a result of end-user environment and application. Specifications subject to change without notice.



### Anchor Base Poles

# SSS

SQUARE STRAIGHT STEEL



# SSS Square Straight Steel Poles

## ORDERING INFORMATION

Lead times will vary depending on options selected. Consult with your sales representative.

**Example:** SSS 20 5C DM19 DDBXD

SSS						
Series	Nominal fixture mounting height	Nominal shaft base size/wall thickness <sup>2</sup>	Mounting <sup>3</sup>		Options	Finish <sup>13</sup>
SSS <sup>1</sup>	10'-39' (for 1/2 ft increments, add -6 to the pole height. Ex: 20-6 equals 20ft 6in.)  See technical information table for complete ordering information.)	4C 4" 11g (.1196") 4G 4" 7g (.1793") 5C 5" 11g (.1196") 5G 5" 7g (.1793") 6G 6" 7g (.1793")  See technical information table for complete ordering information.)	Tenon mounting PT Open top (includes top cap) T20 2-3/8" O.D. (2" NPS) T25 2-7/8" O.D. (2-1/2" NPS) T30 3-1/2" O.D. (3" NPS) T35 4" O.D. (3-1/2" NPS) KAC/KAD/KSE/KSF/KVR/KVE Drill mounting <sup>4</sup> DM19 1 at 90° DM28 2 at 180° DM28 PL 2 at 180° with one side plugged DM29 2 at 90° DM39 3 at 90° DM49 4 at 90° CSX/DSX/R SX/AERIS™/OMERO™/HLA/KAX Drill mounting <sup>4</sup> DM19AS 1 at 90° DM28AS 2 at 180° DM29AS 2 at 90° DM39AS 3 at 90° DM49AS 4 at 90° RAD drill mounting <sup>4</sup> DM19RAD 1 at 90° DM28RAD 2 at 180° DM29RAD 2 at 90° DM39RAD 3 at 90° DM49RAD 4 at 90° ESX Drill mounting <sup>4</sup> DM19ESX 1 at 90° DM28ESX 2 at 180° DM29ESX 2 at 90° DM39ESX 3 at 90° DM49ESX 4 at 90°	AERIS™ Suspend drill mounting <sup>4,5</sup> DM19AST_ 1 at 90° DM28AST_ 2 at 180° DM29AST_ 2 at 90° DM39AST_ 3 at 90° DM49AST_ 4 at 90° OMERO™ Suspend drill mounting <sup>4,5</sup> DM19MRT_ 1 at 90° DM28MRT_ 2 at 180° DM29MRT_ 2 at 90° DM39MRT_ 3 at 90° DM49MRT_ 4 at 90°	Shipped installed VD Vibration damper <sup>6</sup> HAxy Horizontal arm bracket (1 fixture) <sup>7,8</sup> FDLxy Festoon outlet less electrical <sup>7,9</sup> CPL12/xy 1/2" coupling <sup>7</sup> CPL34/xy 3/4" coupling <sup>7</sup> CPL1/xy 1" coupling <sup>7</sup> NPL12/xy 1/2" threaded nipple <sup>7</sup> NPL34/xy 3/4" threaded nipple <sup>7</sup> NPL1/xy 1" threaded nipple <sup>7</sup> EHHxy Extra handhole <sup>7,10</sup> NEC NEC 410.30 compliant gasketed handhole (Not UL Labeled) IC Interior coating <sup>11</sup>  L/AB Less anchor bolts (Include when anchor bolts are not needed) TP Tamper resistant handhole cover fasteners UL UL listed with label (Includes NEC compliant cover) BAA Buy America(n) Act Compliant <sup>12</sup>	Super durable paint colors DDBXD Dark bronze DBLXD Black DNAXD Natural aluminum DWHXD White DDBTXD Textured dark bronze DBL BXD Textured black DNATXD Textured natural aluminum DWHGXD Textured white Other finishes GALV Galvanized finish Architectural colors and special finishes Paint over Galvanized, RAL Colors, Custom Colors and Extended Warranty Finishes available.

### NOTES:

- Handhole covers (HHC), full base covers (FBC) and top caps (TC) shipped separately. No need to call out in nomenclature. For additional parts please order as replacements.
- Wall thickness will be signified with a "C" (11 Gauge) or a "G" (7-Gauge) in nomenclature. "C" - 0.1196" | "G" - 0.1793".
- PT open top poles include top cap. When ordering tenon mounting and drill mounting for the same pole, follow this example: DM28/T20. The combination includes a required extra handhole.
- Refer to the fixture spec sheet for the correct drilling template pattern and orientation compatibility.
- Insert "1" or "2" to designate fixture size; e.g. DM19AST2.
- On 4" and 5" poles, VD cannot be installed if provisions (EHH, FDL, NPL, CPL) are located higher than 2/3 of the pole's total height.  
*Example: Pole height is 25ft, A provision cannot be placed above 16ft.*
- Specify location and orientation when ordering option.  
**For "x":** Specify the height above the base of pole in feet or inches; separate feet and inches with a "-".  
*Example: 5ft = 5 and 20ft 3in = 20-3*  
**For "y":** Specify orientation from handhole (A,B,C,D) Refer to the Handhole Orientation diagram below.  
*Example: 1/2" coupling at 5' 8", orientation C = CPL12/5-8C*
- Horizontal arm is 18" x 2-3/8" O.D. tenon standard, with radius curve providing 12" rise and 2-3/8" O.D. If ordering two horizontal arm at the same height, specify with HAxy. Example: HA20BD.
- FDL does not come with GFCI outlet or handhole cover. These must be supplied by contractor or electrician.
- Combination of tenon-top and drill mount includes extra handhole. EHH includes cover.
- Provides enhanced corrosion resistance.
- Use when mill certifications are required.
- Finish must be specified. Additional colors available; see Architectural Colors brochure linked [here](#) (Form No. 794.3).

<b>Accessories:</b> Order as separate catalog number.	
PL DT20	Plugs for ESX drillings
PL DT8	Plugs for DMxxAS drillings

# SSS Square Straight Steel Poles

TECHNICAL INFORMATION — EPA (ft <sup>2</sup> ) with 1.3 gust													
Catalog Number	Nominal Shaft Length (ft.)*	Pole Shaft Size (Base in. x Top in. x ft.)	Wall thick (in)	Gauge	EPA (ft <sup>2</sup> ) with 1.3 gust						Bolt circle (in)	Bolt size (in. x in. x in.)	Approximate ship weight (lbs.)
					80 MPH	Max. weight	90 MPH	Max. weight	100 MPH	Max. weight			
SSS 10 4C	10	4.0 x 10.0	0.1196	11	30.6	765	23.8	595	18.9	473	8--9	3/4 x 18 x 3	75
SSS 12 4C	12	4.0 x 12.0	0.1196	11	24.4	610	18.8	470	14.8	370	8--9	3/4 x 18 x 3	90
SSS 14 4C	14	4.0 x 14.0	0.1196	11	19.9	498	15.1	378	11.7	293	8--9	3/4 x 18 x 3	100
SSS 16 4C	16	4.0 x 16.0	0.1196	11	15.9	398	11.8	295	8.9	223	8--9	3/4 x 18 x 3	115
SSS 18 4C	18	4.0 x 18.0	0.1196	11	12.6	315	9.2	230	6.7	168	8--9	3/4 x 18 x 3	125
SSS 20 4C	20	4.0 x 20.0	0.1196	11	9.6	240	6.7	167	4.5	150	8--9	3/4 x 18 x 3	140
SSS 20 4G	20	4.0 x 20.0	0.1793	7	14	350	11	275	8	200	8--9	3/4 x 30 x 3	198
SSS 20 5C	20	5.0 x 20.0	0.1196	11	17.7	443	12.7	343	9.4	235	10--12	1 x 36 x 4	185
SSS 20 5G	20	5.0 x 20.0	0.1793	7	28.1	703	21.4	535	16.2	405	10--12	1 x 36 x 4	265
SSS 25 4C	25	4.0 x 25.0	0.1196	11	4.8	150	2.6	100	1	50	8--9	3/4 x 18 x 3	170
SSS 25 4G	25	4.0 x 25.0	0.1793	7	10.8	270	7.7	188	5.4	135	8--9	3/4 x 30 x 3	245
SSS 25 5C	25	5.0 x 25.0	0.1196	11	9.8	245	6.3	157	3.7	150	10--12	1 x 36 x 4	225
SSS 25 5G	25	5.0 x 25.0	0.1793	7	18.5	463	13.3	333	9.5	238	10--12	1 x 36 x 4	360
SSS 30 4G	30	4.0 x 30.0	0.1793	7	6.7	168	4.4	110	2.6	65	8--9	3/4 x 30 x 3	295
SSS 30 5C	30	5.0 x 30.0	0.1196	11	4.7	150	2	50	--	--	10--12	1 x 36 x 4	265
SSS 30 5G	30	5.0 x 30.0	0.1793	7	10.7	267	6.7	167	3.9	100	10--12	1 x 36 x 4	380
SSS 30 6G	30	6.0 x 30.0	0.1793	7	19	475	13.2	330	9	225	11--13	1 x 36 x 4	520
SSS 35 5G	35	5.0 x 35.0	0.1793	7	5.9	150	2.5	100	--	--	10--12	1 x 36 x 4	440
SSS 35 6G	35	6.0 x 35.0	0.1793	7	12.4	310	7.6	190	4.2	105	11--13	1 x 36 x 4	540
SSS 39 6G	39	6.0 x 39.0	0.1793	7	7.2	180	3	75	--	--	11--13	1 x 36 x 4	605

NOTE: \* EPA values are based ASCE 7-93 wind map. For 1/2 ft increments, add -6 to the pole height. Ex: 20-6 equals 20ft 6in.

## BASE DETAIL

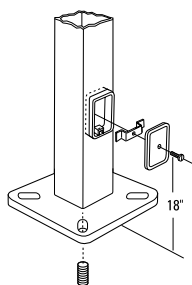

POLE DATA								
Shaft base size	Bolt circle A	Bolt projection B	Base diameter C	Base plate thickness	Template description	Anchor bolt description	Anchor bolt and template number	Anchor bolt description
4"C	8" - 9"	3.25" - 3.75"	8" - 8.25"	0.75"	ABTEMPLATE PJ50004	AB18-0	ABSSS-4C	3/4"x18"x3"
4"G	8" - 9"	3.38" - 3.75"	8" - 8.25"	0.875"	ABTEMPLATE PJ50004	AB30-0	ABSSS-4G	3/4"x30"x3"
5"	10" - 12"	3.5" - 4"	11"	1"	ABTEMPLATE PJ50010	AB36-0	ABSSS-5	1"x36"x4"
6"	11" - 13"	4" - 4.50"	12.5"	1"	ABTEMPLATE PJ50011	AB36-0	N/A	1"x36"x4"

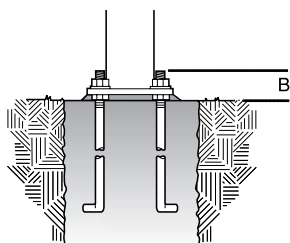
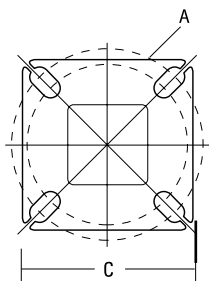

## HANDHOLE ORIENTATION

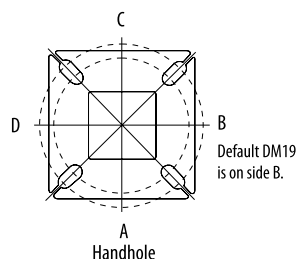

## IMPORTANT INSTALLATION NOTES:

- Do not erect poles without having fixtures installed.
- Factory-supplied templates must be used when setting anchor bolts. Lithonia Lighting will not accept claim for incorrect anchorage placement due to failure to use Lithonia Lighting factory templates.
- If poles are stored outside, all protective wrapping must be removed immediately upon delivery to prevent finish damage.
- Lithonia Lighting is not responsible for the foundation design.
- Bolt circles have +/- 1/2" tolerance.

CAUTION: These specifications are intended for general purposes only. Lithonia Lighting reserves the right to change material or design, without prior notice, in a continuing effort to upgrade its products.