

**1** AREA 1.1 LIGHTING PLAN  
SCALE: 1" = 40'

GENERAL NOTES

1. PHOTOMETRIC PLAN SUBMITTED PURSUANT TO CITY OF EAGLE APPLICABLE CODES, INCLUDING CODE OF ORDINANCES CHAPTER 4.13 OUTDOOR LIGHTING.
2. ALL LIGHT SOURCES TO BE 3000K CCT.
3. ALL LIGHT SOURCES SHALL BE SHIELDED SO THAT LIGHT WILL NOT SHINE ONTO ADJACENT PROPERTIES.
4. ALL EXTERIOR LIGHTING SHALL BE INSTALLED IN SUCH A MANNER THAT THE LIGHT SOURCE WILL BE SUFFICIENTLY OBSCURED TO PERVENT EXCESSIVE GLARE ONTO PUBLIC STREETS.
5. PHOTOMETRIC HORIZONTAL FC POINTS INDICATED ARE BASED ON A 10'-0" SPACING AND CALCULATED AT FINISHED GRADE.
6. ALL LIGHT FIXTURES ON PROJECT TO BE TYPE 'EB1' BOLLARD.

LEGEND

BOLLARD - DIRECTIONAL

LIGHTING PHOTOMETRIC STATS					
AREA	AVERAGE	MAX	MIN	MAX/MIN	AVG/MIN
WHOLE SITE	0.0 FC	26.8 FC	0.0 FC	N/A	N/A
ROADWAY	0.1 FC	26.8 FC	0.0 FC	N/A	N/A
PROPERTY LINE	0.0 FC	0.0 FC	0.0 FC	N/A	N/A

PROJECT

RED MOUNTAIN RANCH

PARCEL 1  
17500 US-6  
EAGLE, CO 81631

ARCHITECT/  
GENERAL CONTRACTOR

tres birds

PROJECT TEAM

MIKE MOORE  
303-324-3622  
MMM@TRESBIRDS.COM

DOUG NEWBY  
720-563-7289  
DN@TRESBIRDS.COM

DAVID HOFFMAN  
561-386-5528  
DH@TRESBIRDS.COM

NOT FOR CONSTRUCTION

COPYRIGHT 2025  
TRES BIRDS  
ALL RIGHTS RESERVED  
  
ALL DRAWINGS CREATED BY THIS OFFICE ARE  
COPYRIGHTED UNDER THE ARCHITECTURAL  
WORKS COPYRIGHT ACT OF 1991. ANY USE OF  
THE INFORMATION APPEARING HEREON,  
INCLUDING COPYING OR MODIFICATION OF THE  
ORIGINAL DESIGN, IS PROHIBITED WITHOUT  
EXPRESS WRITTEN CONSENT.

CONSULTANTS

STRUCTURAL ENGINEERING  
KL&A  
JAKE HOHMANN, PE  
JHOHMANN@KLAA.COM  
303-384-9910

LANDSCAPE  
WENK ASSOCIATES  
TYLER KIGGINS  
TKIGGINS@WENKLA.COM  
720-669-3112

CIVIL ENGINEERING  
WILSON & CO  
BEN BEISLER  
BEN.BEISLER@WILSONCO.COM  
303-501-1217

MEP ENGINEERING  
EV STUDIO  
ERIC REITAN  
ERIC.REITAN@EVSTUDIO.COM  
303-670-7242

ISSUANCE

PRELIMINARY  
PLAT

ISSUE DATE

01.13.2025

CURRENT REVISION

REVISION HISTORY

DRAWING SHEET TITLE

Area 1.1  
Lighting Plan

PH-001

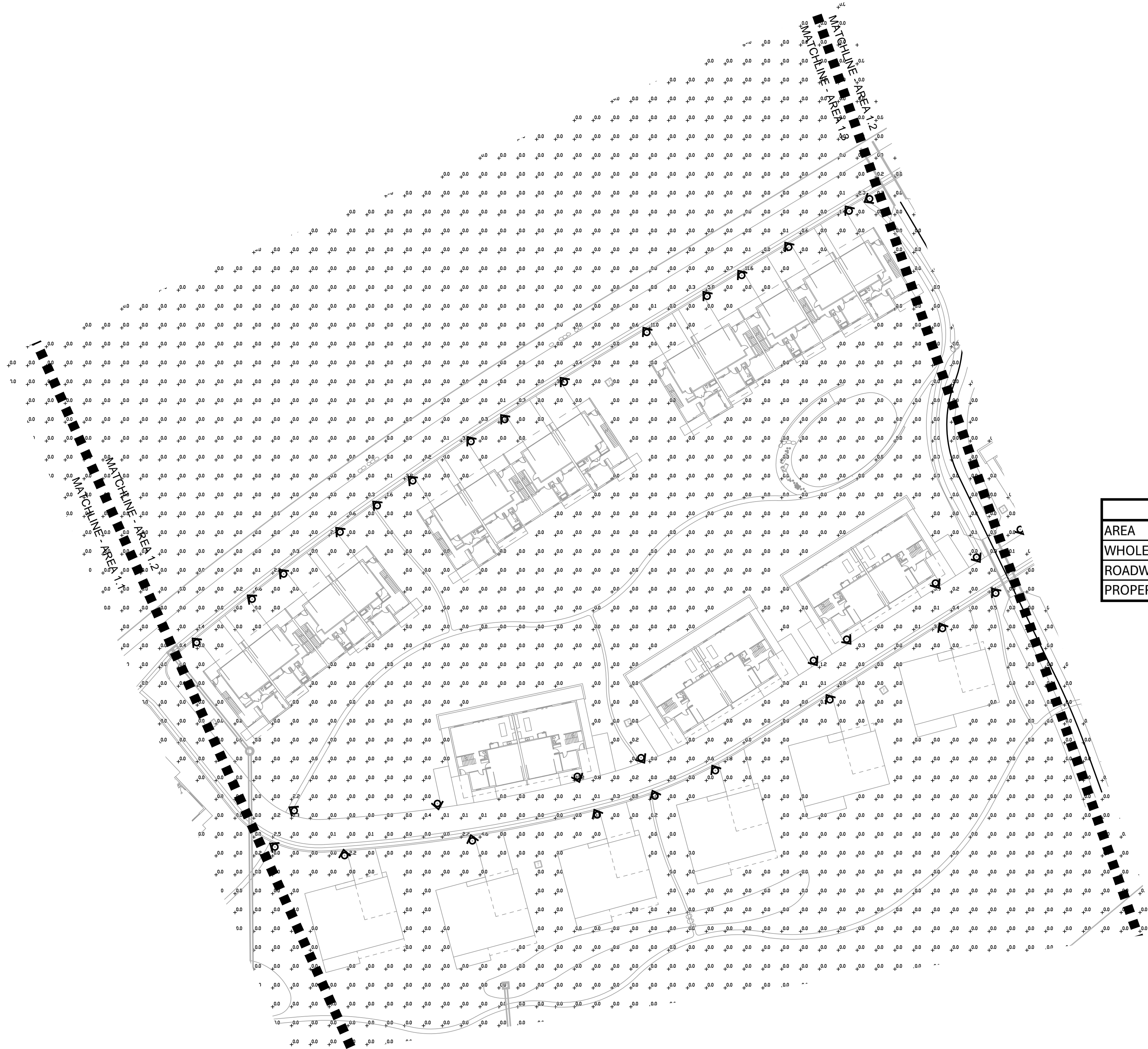

GENERAL NOTES

- 1. PHOTOMETRIC PLAN SUBMITTED PURSUANT TO CITY OF EAGLE APPLICABLE CODES, INCLUDING CODE OF ORDINANCES CHAPTER 4.13 OUTDOOR LIGHTING.
- 2. ALL LIGHT SOURCES TO BE 3000K CCT.
- 3. ALL LIGHT SOURCES SHALL BE SHIELDED SO THAT LIGHT WILL NOT SHINE ONTO ADJACENT PROPERTIES.
- 4. ALL EXTERIOR LIGHTING SHALL BE INSTALLED IN SUCH A MANNER THAT THE LIGHT SOURCE WILL BE SUFFICIENTLY OBSCURED TO PERVENT EXCESSIVE GLARE ONTO PUBLIC STREETS.
- 5. PHOTOMETRIC HORIZONTAL FC POINTS INDICATED ARE BASED ON A 10'-0" SPACING AND CALCULATED AT FINISHED GRADE.
- 6. ALL LIGHT FIXTURES ON PROJECT TO BE TYPE 'EB1' BOLLARD.

LEGEND

 BOLLARD - DIRECTIONAL

LIGHTING PHOTOMETRIC STATS					
AREA	AVERAGE	MAX	MIN	MAX/MIN	AVG/MIN
WHOLE SITE	0.0 FC	26.8 FC	0.0 FC	N/A	N/A
ROADWAY	0.1 FC	26.8 FC	0.0 FC	N/A	N/A
PROPERTY LINE	0.0 FC	0.0 FC	0.0 FC	N/A	N/A

PROJECT

RED MOUNTAIN RANCH

PARCEL 1  
17500 US-6  
EAGLE, CO 81631

ARCHITECT/  
GENERAL CONTRACTOR

tres birds

PROJECT TEAM

MIKE MOORE  
303-324-3622  
MMM@TRESBIRDS.COM

DOUG NEWBY  
720-563-7289  
DN@TRESBIRDS.COM

DAVID HOFFMAN  
561-386-5528  
DH@TRESBIRDS.COM

NOT FOR CONSTRUCTION

COPYRIGHT 2025  
TRES BIRDS  
ALL RIGHTS RESERVED  
ALL DRAWINGS CREATED BY THIS OFFICE ARE  
COPYRIGHTED UNDER THE ARCHITECTURAL  
WORKS COPYRIGHT ACT OF 1991. ANY USE OF  
THE INFORMATION APPEARING HEREON,  
INCLUDING COPYING OR MODIFICATION OF THE  
ORIGINAL DESIGN, IS PROHIBITED WITHOUT  
EXPRESS WRITTEN CONSENT.

CONSULTANTS

STRUCTURAL ENGINEERING  
KL&A  
JAKE HOHMANN, PE  
JHOHMANN@KLAA.COM  
303-384-9910

LANDSCAPE  
WENK ASSOCIATES  
TYLER KIGGINS  
TKIGGINS@WENKLA.COM  
720-669-3112

CIVIL ENGINEERING  
WILSON & CO  
BEN BEISLER  
BEN.BEISLER@WILSONCO.COM  
303-501-1217

MEP ENGINEERING  
EV STUDIO  
ERIC REITAN  
ERIC.REITAN@EVSTUDIO.COM  
303-670-7242

ISSUANCE

PRELIMINARY PLAT

ISSUE DATE

01.13.2025

CURRENT REVISION

REVISION HISTORY

DRAWING SHEET TITLE

Area 1.2  
Lighting Plan

PH-002

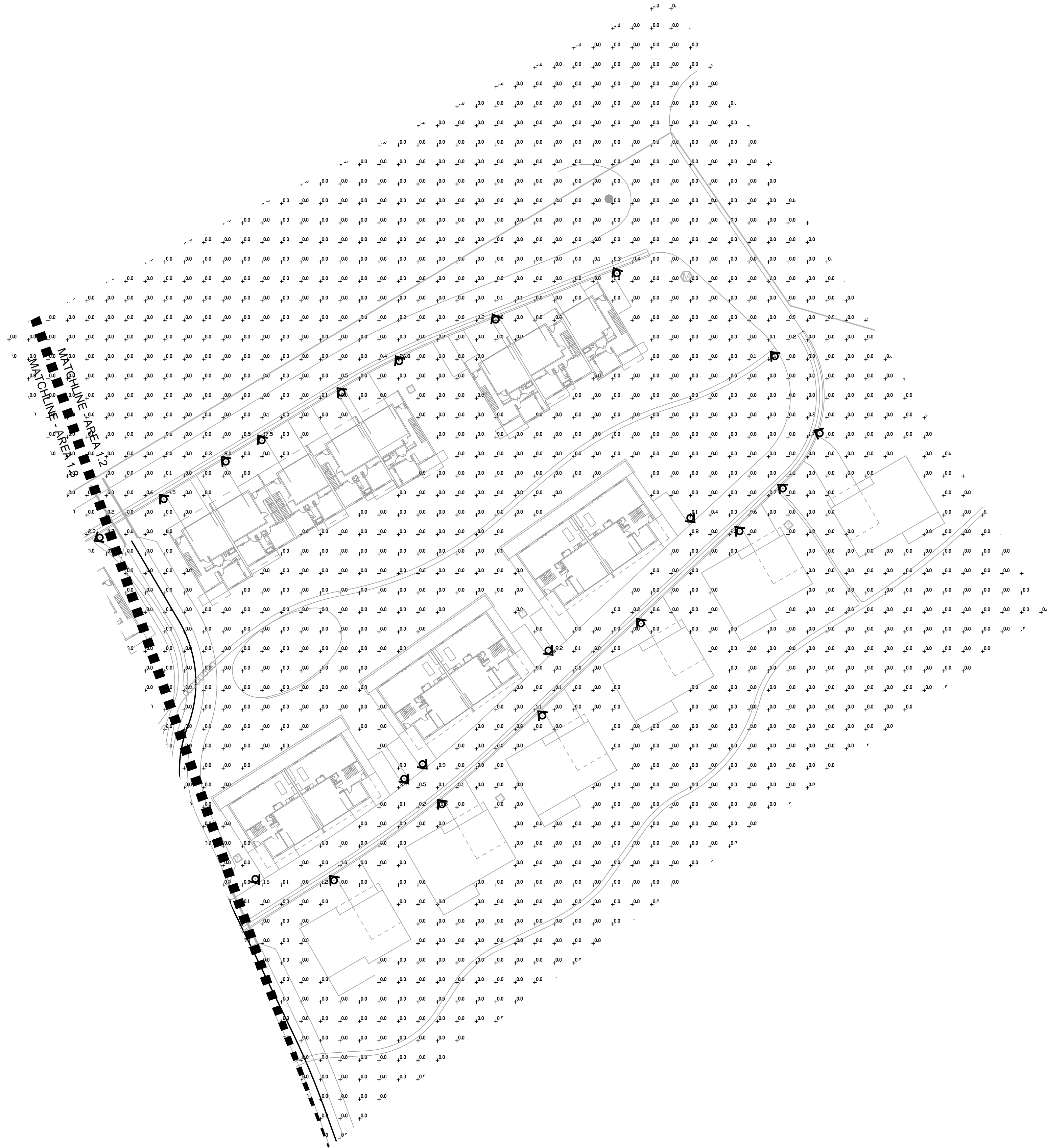

GENERAL NOTES

- 1. PHOTOMETRIC PLAN SUBMITTED PURSUANT TO CITY OF EAGLE APPLICABLE CODES, INCLUDING CODE OF ORDINANCES CHAPTER 4.13 OUTDOOR LIGHTING.
- 2. ALL LIGHT SOURCES TO BE 3000K CCT.
- 3. ALL LIGHT SOURCES SHALL BE SHIELDED SO THAT LIGHT WILL NOT SHINE ONTO ADJACENT PROPERTIES.
- 4. ALL EXTERIOR LIGHTING SHALL BE INSTALLED IN SUCH A MANNER THAT THE LIGHT SOURCE WILL BE SUFFICIENTLY OBSCURED TO PERVENT EXCESSIVE GLARE ONTO PUBLIC STREETS.
- 5. PHOTOMETRIC HORIZONTAL FC POINTS INDICATED ARE BASED ON A 10'-0" SPACING AND CALCULATED AT FINISHED GRADE.
- 6. ALL LIGHT FIXTURES ON PROJECT TO BE TYPE 'EB1' BOLLARD.

LEGEND

 BOLLARD - DIRECTIONAL

LIGHTING PHOTOMETRIC STATS					
AREA	AVERAGE	MAX	MIN	MAX/MIN	AVG/MIN
WHOLE SITE	0.0 FC	26.8 FC	0.0 FC	N/A	N/A
ROADWAY	0.1 FC	26.8 FC	0.0 FC	N/A	N/A
PROPERTY LINE	0.0 FC	0.0 FC	0.0 FC	N/A	N/A

PROJECT

RED MOUNTAIN RANCH

PARCEL 1  
17500 US-6  
EAGLE, CO 81631

ARCHITECT/  
GENERAL CONTRACTOR

tres birds

PROJECT TEAM

MIKE MOORE  
303-324-3622  
MMM@TRESBIRDS.COM

DOUG NEWBY  
720-563-7289  
DN@TRESBIRDS.COM

DAVID HOFFMAN  
561-386-5528  
DH@TRESBIRDS.COM

NOT FOR CONSTRUCTION

COPYRIGHT 2025  
TRES BIRDS  
ALL RIGHTS RESERVED  
ALL DRAWINGS CREATED BY THIS OFFICE ARE  
COPYRIGHTED UNDER THE ARCHITECTURAL  
WORKS COPYRIGHT ACT OF 1991. ANY USE OF  
THE INFORMATION APPEARING HEREON,  
INCLUDING COPYING OR MODIFICATION OF THE  
ORIGINAL DESIGN, IS PROHIBITED WITHOUT  
EXPRESS WRITTEN CONSENT

CONSULTANTS

STRUCTURAL ENGINEERING

KL&A  
JAKE HOHMANN, PE  
JHOHMANN@KLAA.COM  
303-384-9910

LANDSCAPE

WENK ASSOCIATES  
TYLER KIGGINS  
TKIGGINS@WENKLA.COM  
720-669-3112

CIVIL ENGINEERING

WILSON & CO  
BEN BEISLER  
BEN.BEISLER@WILSONCO.COM  
303-501-1217

MEP ENGINEERING

EV STUDIO  
ERIC REITAN  
ERIC.REITAN@EVSTUDIO.COM  
303-670-7242

ISSUANCE

PRELIMINARY PLAT

ISSUE DATE

01.13.2025

CURRENT REVISION

REVISION HISTORY

DRAWING SHEET TITLE

Area 1.3  
Lighting Plan

PH-003



FLINDT BOLLARD

Designed by Christian Flindt

Light distribution diagrams

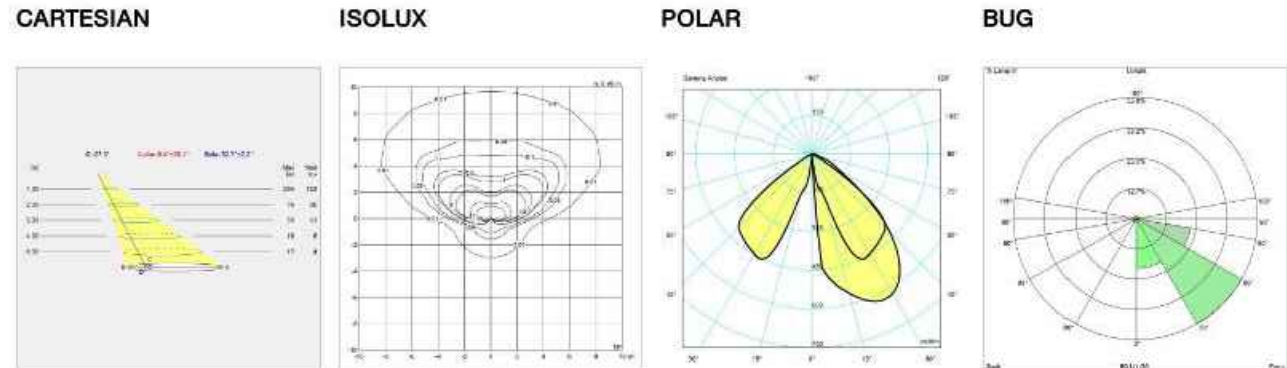

Variant Options

For particular variant options, please check our online Product Variants Configurator on the product detail page.

VARIANT NO.	LIGHT SOURCE	VOLTAGE/FRQ	LUMEN	FEATURES	CABLE
10000162742	LED 3000K 15W	120-277V/60HZ	707	Dim 0-10v	-
10000162743	LED 3000K 15W	120-277V/60HZ	707	Dim 0-10v	-
10000162746	LED 3000K 15W	120-277V/60HZ	762	Dim 0-10v	-
10000162747	LED 3000K 15W	120-277V/60HZ	762	Dim 0-10v	-
10000162760	LED 4000K 15W	120-277V/60HZ	757	Dim 0-10v	-
10000162761	LED 4000K 15W	120-277V/60HZ	757	Dim 0-10v	-
10000162762	LED 4000K 15W	120-277V/60HZ	784	Dim 0-10v	-
10000162763	LED 4000K 15W	120-277V/60HZ	784	Dim 0-10v	-
10000162764	LED 3000K 15W	120-277V/60HZ	707	Dim 0-10v	-
10000162765	LED 3000K 15W	120-277V/60HZ	707	Dim 0-10v	-
10000162766	LED 3000K 15W	120-277V/60HZ	707	Dim 0-10v	-
10000162767	LED 3000K 15W	120-277V/60HZ	762	Dim 0-10v	-
10000162768	LED 3000K 15W	120-277V/60HZ	762	Dim 0-10v	-
10000162769	LED 3000K 15W	120-277V/60HZ	762	Dim 0-10v	-
10000162770	LED 4000K 15W	120-277V/60HZ	757	Dim 0-10v	-
10000162771	LED 4000K 15W	120-277V/60HZ	757	Dim 0-10v	-
10000162772	LED 4000K 15W	120-277V/60HZ	757	Dim 0-10v	-
10000162773	LED 4000K 15W	120-277V/60HZ	784	Dim 0-10v	-
10000162774	LED 4000K 15W	120-277V/60HZ	784	Dim 0-10v	-
10000162775	LED 4000K 15W	120-277V/60HZ	784	Dim 0-10v	-

FLINDT BOLLARD

Designed by Christian Flindt

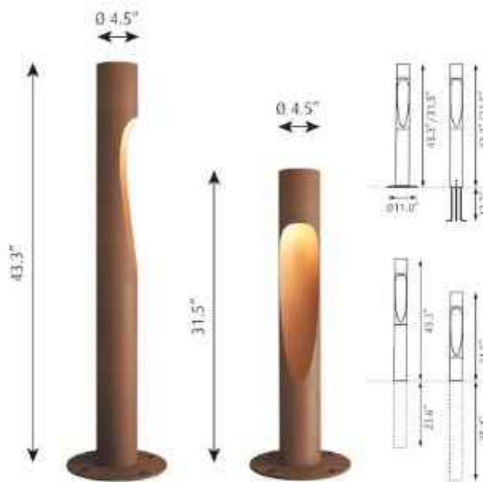

Technical specifications

<b>Materials</b> Top: Cast aluminum. Post: Extruded aluminum. Base plate: Die cast aluminum. Lens: Clear polycarbonate. Anchor bolts: Zinc-plated steel.	<b>Information</b> Electrical: System Wattage: 15W LED Wattage: 14W Delivered lumens: 536-591 lm Efficacy: 35.7-39.4 lm/W
<b>Finishes</b> Aluminum, Corten, or Black colored. Textured surface, powder coated.	<b>Certifications:</b> cULus, Wet Location Protection class IP65 IK class 10 BUG Rating: B0-U2-G1 Controllability: 0-10V Dimming Min.-Max. Ambient Temp: -40°C to +70°C Color Rendering: Ra>80 For the E-socket product variants, bulbs are not included. LED light source is part of the product.
<b>Mounting</b> Base plate dimension: 11" diameter. Base plate: Mounted to a concrete base with 4 anchor bolts on a bolt circle of 8.9" diameter.	
Internal anchor base: Mounted to a concrete base with 3 anchor bolts on a bolt circle of 3.5".	
Direct burial: includes cross-bar for stabilization and slots for conduit entry. Installation: Refer to mounting instruction download for installation details. For mounting instructions, see download section on the product detail page.	

Showroom

louis poulsen

Light source guide

Showroom

louis poulsen

Light source guide

1 TYPE EB1

SCALE: N.T.S.

LIGHTING PHOTOMETRIC STATS					
AREA	AVERAGE	MAX	MIN	MAX/MIN	AVG/MIN
WHOLE SITE	0.0 FC	26.8 FC	0.0 FC	N/A	N/A
ROADWAY	0.1 FC	26.8 FC	0.0 FC	N/A	N/A
PROPERTY LINE	0.0 FC	0.0 FC	0.0 FC	N/A	N/A

LUMINAIRE SCHEDULE													
CALLOUT	DESCRIPTION	LAMPS		VOLTAGE	BALLAST OR DRIVER VA	MOUNTING	SHIELDING	CRI AND CCT	LUMEN OUTPUT	DIMMING TYPE	DESIGN BASIS MODEL NUMBER	ACCEPTABLE MANUFACTURERS	NOTE
		QUANTITY	TYPE										
EB1	LED FULL CUTOFF BOLLARD, 43.3"H X 4.5" DIAMETER, DIRECTIONAL	1	LED	120-277V	15	GROUND BOLLARD 43.4"H	FULL CUTOFF	80CRI, 3000K	762	0-10V	10000162767, FLINDT BOLLARD	LOUIS POULSEN	
NOTES: 1 LUMINAIRES INDICATED ABOVE WERE USED AS A BASIS FOR DESIGN. 2 CATALOG NUMBERS INDICATE BASIC LUMINAIRE TYPES REQUIRED FOR THIS PROJECT. VERIFY WITH MANUFACTURER TO INCLUDE ALL ACCESSORIES REQUIRED FOR ACTUAL INSTALLATION TO SUIT FIELD CONDITIONS.													

PROJECT

RED MOUNTAIN RANCH

PARCEL 1  
17500 US-6  
EAGLE, CO 81631

ARCHITECT/  
GENERAL CONTRACTOR

tres birds

PROJECT TEAM

MIKE MOORE  
303-324-3622  
MMM@TRESBIRDS.COM

DOUG NEWBY  
720-563-7289  
DN@TRESBIRDS.COM

DAVID HOFFMAN  
561-386-5528  
DH@TRESBIRDS.COM

NOT FOR CONSTRUCTION

COPYRIGHT 2025  
TRES BIRDS  
ALL RIGHTS RESERVED  
  
ALL DRAWINGS CREATED BY THIS OFFICE ARE  
COPYRIGHTED UNDER THE ARCHITECTURAL  
WORKS COPYRIGHT ACT OF 1991. ANY USE OF  
THE INFORMATION APPEARING HEREON,  
INCLUDING COPYING OR MODIFICATION OF THE  
ORIGINAL DESIGN, IS PROHIBITED WITHOUT  
EXPRESS WRITTEN CONSENT.

CONSULTANTS

STRUCTURAL ENGINEERING  
KL&A  
JAKE HOHMANN, PE  
JHOHMANN@KLAA.COM  
303-384-9910

LANDSCAPE  
WENK ASSOCIATES  
TYLER KIGGINS  
TKIGGINS@WENKLA.COM  
720-669-3112

CIVIL ENGINEERING  
WILSON & CO  
BEN BEISLER  
BEN.BEISLER@WILSONCO.COM  
303-501-1217

MEP ENGINEERING  
EV STUDIO  
ERIC REITAN  
ERIC.REITAN@EVSTUDIO.COM  
303-670-7242

ISSUANCE

PRELIMINARY PLAT

ISSUE DATE

01.13.2025

CURRENT REVISION

REVISION HISTORY

DRAWING SHEET TITLE

Lighting  
Photometric  
Details

PH-004